

Absorbant Glass Mat (AGM) technology for superior performance. Valve regulated, spill proof construction allows safe operation in any position. Approved for transport by air. D.O.T., I.A.T.A., F.A.A. and C.A.B. certified. U.L. recognized under file number MH 20567.

Maintenance-Free

Specification

Nominal Voltage	12 volts	
Nominal Capacity	77° F (25° C)	
20-hr. (1.65A)	33.0 Ah	
10-hr. (3.07A)	30.7 Ah	
5-hr. (5.62A)	28.1 Ah	
1-hr. (19.8A)	19.8 Ah	
Approximate Weight	22.1 lbs (10.0 kgs)	
Internal Resistance (approx.)	12mΩ	
Shelf Life (% of normal capacity at 68° F (20° C))		
3 Months	6 Months	12 Months
91%	82%	64%
AGM Operational Temperature		
Charge	32°F to 104°F (0°C to 40°C)	
Discharge	5°F to 113°F (-15°C to 45°C)	
AGM Storage Temperature	5°F to 104°F (-15°C to 40°C)	
Case	Polypropylene	



Due to continuous improvements to our products, product may vary slightly from depiction.

Charge Method (Constant Voltage)

Cycle Use (Repeating Use)

Initial Current	9.9 A or smaller
Control Voltage	14.6 - 14.8 V

Float Use

Control Voltage	13.6 - 13.8 V
-----------------	---------------

Physical Dimensions: in (mm)

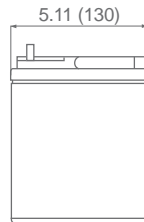
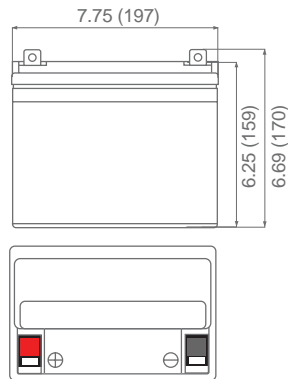

L: 7.75 in (197 mm)
W: 5.11 in (130 mm)
H: 6.25 in (159 mm)
TH: 6.69 in (170 mm)

Tolerances are +/- 0.04 in. (+/- 1mm) and +/- 0.08 in. (+/- 2mm) for height dimensions. All data subject to change without notice.

Terminals

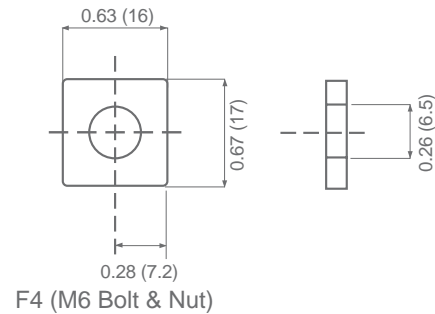

Constant Current Discharge Characteristics Unit: A (25°C, 77°F)

F.V/Time	5MIN	15MIN	30MIN	60MIN	2HR	3HR	5HR	8HR	10HR	20HR
1.60V	115.0	63.0	38.3	20.6	12.0	8.87	6.11	4.00	3.32	1.71
1.67V	112.0	62.0	38.0	19.9	11.6	8.61	5.91	3.96	3.28	1.70
1.70V	104.0	60.0	37.2	19.5	11.4	8.25	4.97	3.90	3.21	1.68
1.75V	97.0	55.5	36.2	19.2	11.1	8.03	4.87	3.84	3.15	1.65
1.80V	88.0	52.1	34.5	18.8	10.5	7.88	4.74	3.78	3.07	1.64

Constant Power Discharge Characteristics Unit: W (25°C, 77°F)

F.V/Time	5MIN	15MIN	30MIN	60MIN	2HR	3HR	5HR	8HR	10HR	20HR
1.60V	1200.0	680.0	380.0	238.0	148.0	101.0	70.2	45.6	40.00	21.90
1.67V	1181.0	670.0	372.5	235.1	145.0	99.5	68.2	45.5	39.80	21.00
1.70V	1075.0	642.0	364.7	133.1	144.0	98.2	67.5	45.1	39.60	20.72
1.75V	978.0	593.0	356.2	230.5	143.0	97.6	66.2	44.5	39.50	20.52
1.80V	850.0	534.0	346.3	208.0	140.2	95.8	64.5	44.2	39.40	19.79



ISO 9001:2008

Made in Vietnam

All specifications subject to change without notice.

www.upgi.com

488 S. Royal Lane | Coppell, Texas 75019 | P 469.892.1122 | T 866.892.1122 | F 469.892.1123 | sales@upgi.com

Copyright © 2015 Universal Power Group. All rights reserved.

U1506-1

Discharge Time vs. Discharge Current

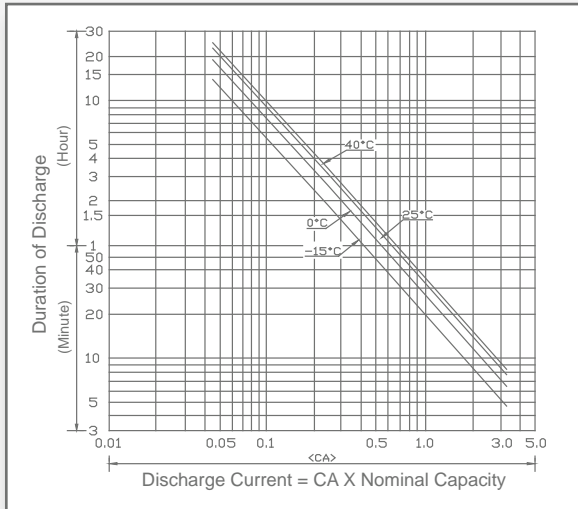

Discharge Characteristics

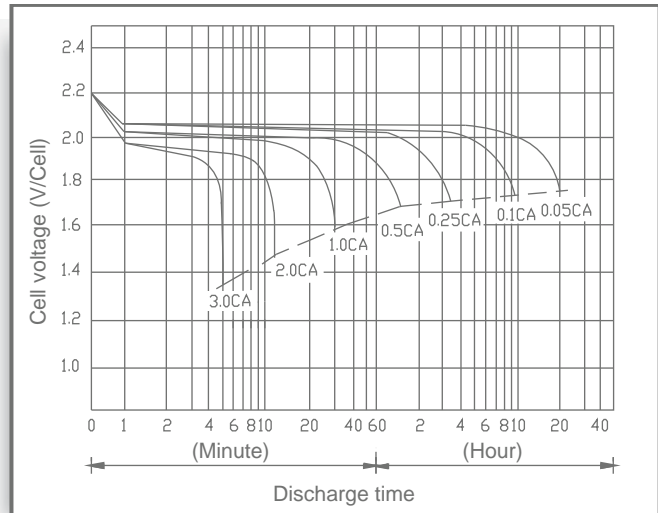

Shelf Life & Storage

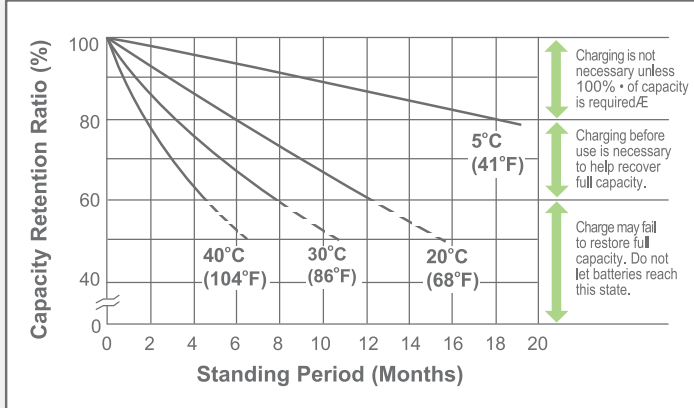

Cycle Life vs. Depth of Discharge

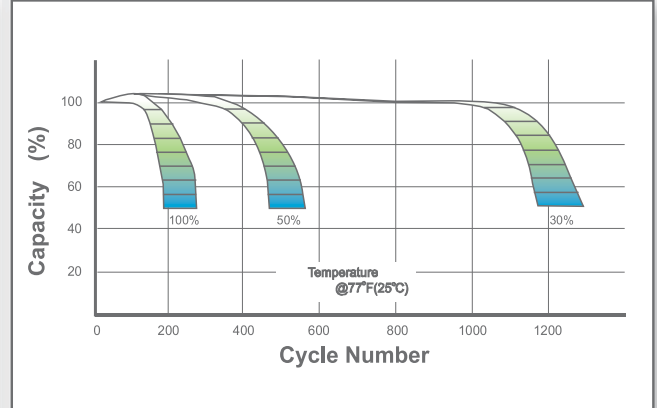

Open Circuit Voltage vs. Residual Capacity

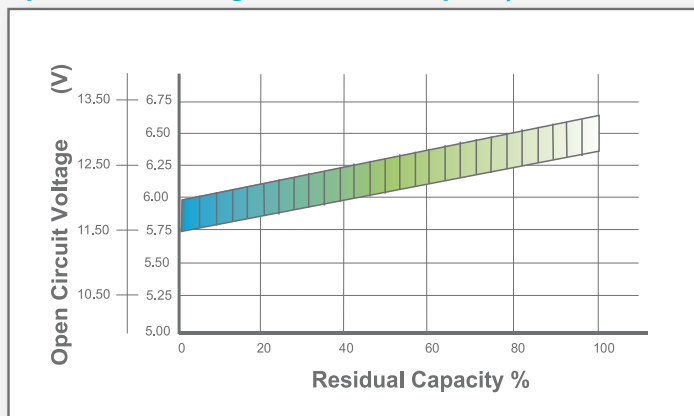

Effect of Temperature on Capacity

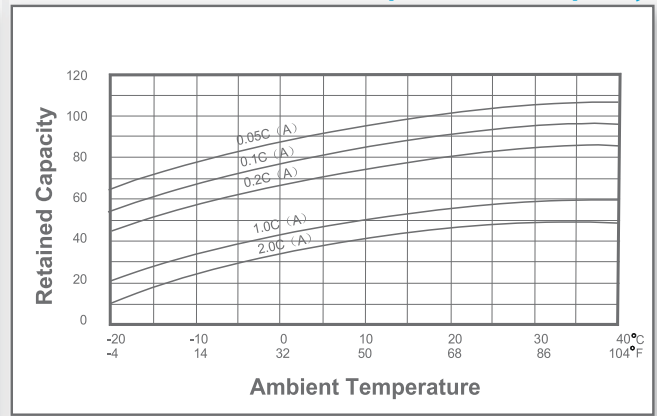

Charge Current & Final Discharge Voltage

Application	Charge Voltage(V/Cell)			Max.Charge Current	Final Discharge Voltage V/Cell	Discharge Current(A)		
	Temperature	Set Point	Allowable Range					
Cycle Use	25°C(77°F)	2.45	2.43-2.47	0.30C	1.75	1.70		
Standby	25°C(77°F)	2.28	2.27-2.30		1.60	1.30		
					0.2C>(A)	0.2C<(A)<0.5C	0.5C<(A)<1.0C	(A)>1.0C



ISO 9001 :2008

Let UPG Power Your Life.

www.upgi.com