



UPG Sealed Lead-Acid Battery

STAY POWERED®

Absorbent Glass Mat (AGM) technology for superior performance. Valve regulated, spill proof construction allows safe operation in any position. Approved for transport by air. D.O.T., I.A.T.A., F.A.A. and C.A.B. certified. U.L. recognized under file number MH 20567.

UPG No. 40658

UB12150

Maintenance-Free



Specification

Nominal Voltage	12 volts (6 cells)		
Nominal Capacity			
20-hr. (0.75A)	15.0 AH		
10-hr. (1.395A)	13.95 AH		
5-hr. (2.55A)	12.75 AH		
1-hr. (9.0A)	9.0 AH		
Approximate Weight	9.2 lbs. (4.2 kg)		
Internal Resistance (approx.)	18mΩ		
Shelf Life (% of normal capacity at 77° F (25° C))			
3 Months	6 Months	12 Months	
91%	82%	64%	
Temperature Dependency of Capacity			
104° F	77° F	32° F	5° F
102%	100%	85%	65%

Charge Method (Constant Voltage)

Cycle Use (Repeating Use)

Initial Current	4.5 A or smaller
Control Voltage	14.5 - 14.9 V
Float Use	
Control Voltage	13.6 - 13.8 V

Physical Dimensions: in (mm)

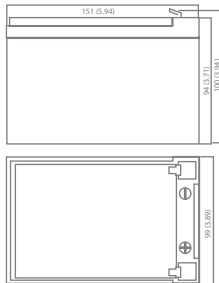

L: 5.95in (151 mm)
W: 3.89in (99 mm)
H: 3.71in (94 mm)
TH: 3.94in (100 mm)
 Tolerances are +/- 0.04 in. (+/- 1mm) and +/- 0.08 in. (+/- 2mm) for height dimensions. All data subject to change without notice.

Terminals

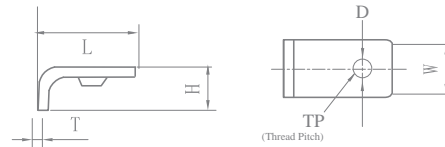

Type	Dimension	L	W	H	D	TP
0.31 inch tab with a hole for a 4mm screw		12.8	7.8	5.00	4.00	0.70

Discharge Time vs. Discharge Current

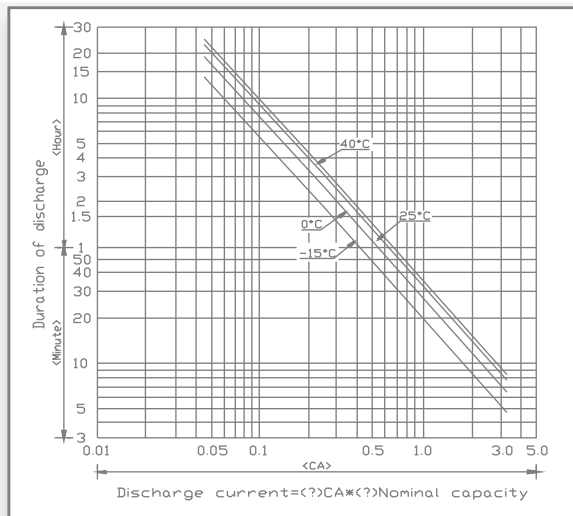

Discharge Characteristics

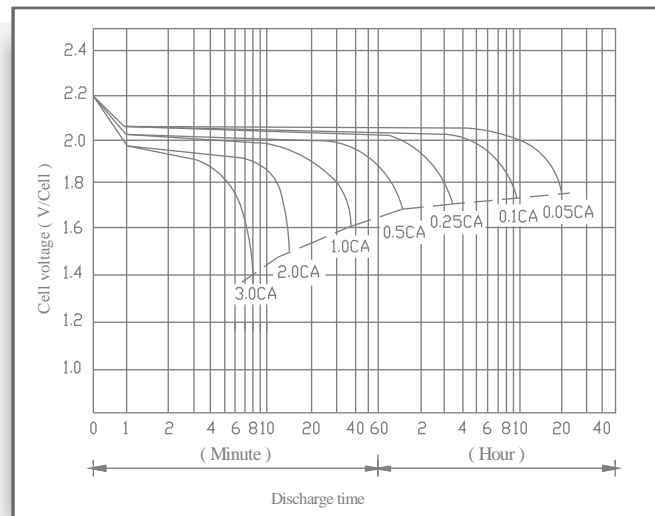

Battery Charging Characteristics for Standby Use

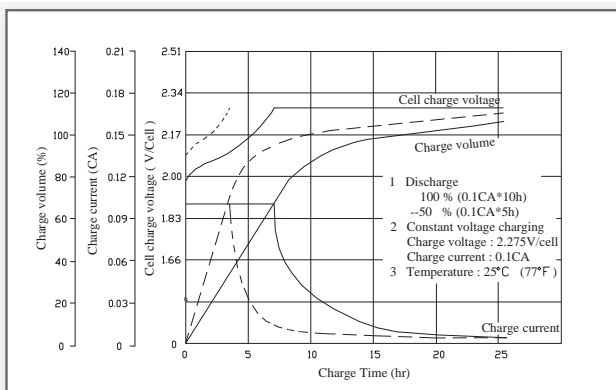

Battery Charging Characteristics for Cyclic Use

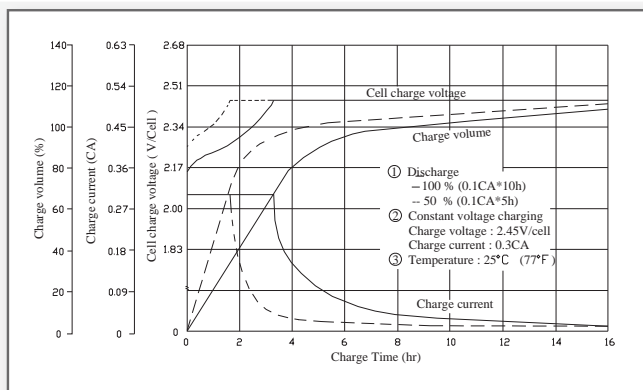

Shelf Life & Storage

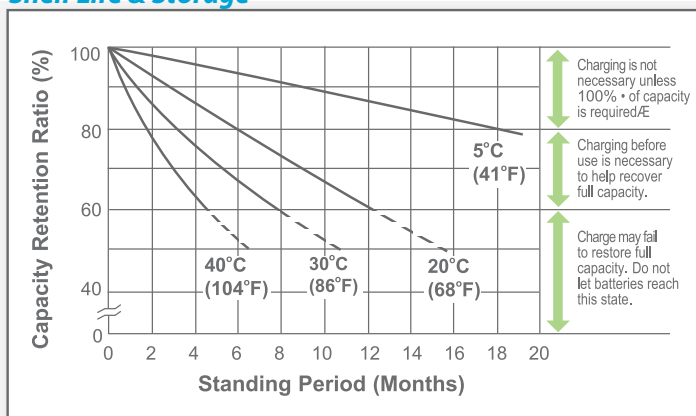

Cycle Life vs Depth of Discharge

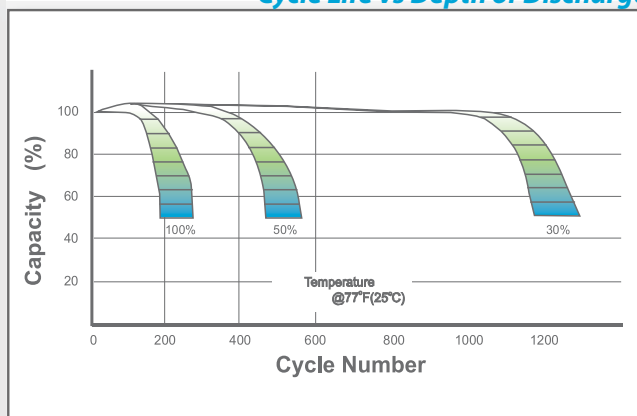

Open Circuit Voltage vs Residual Capacity

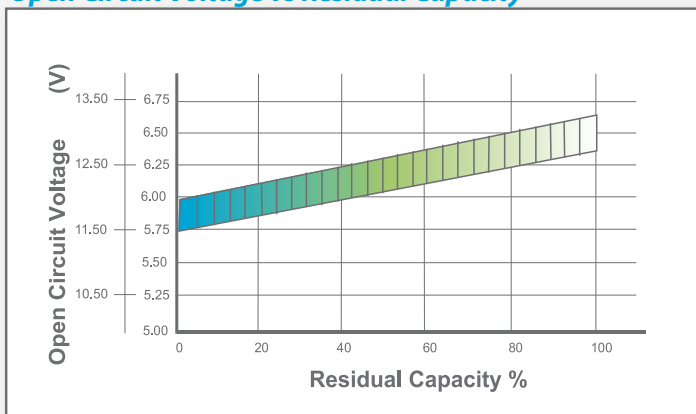

Effect of Temperature on Capacity

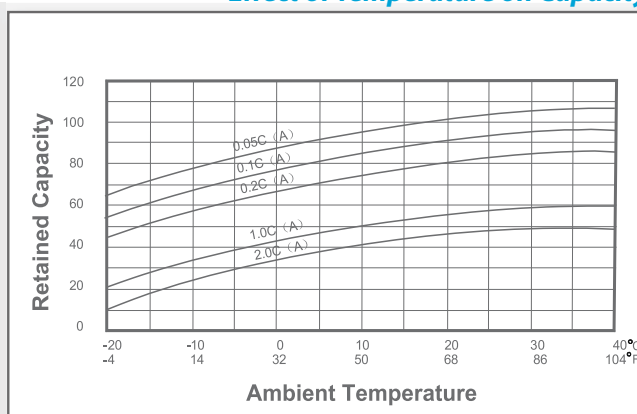

Charge Current & Final Discharge Voltage

Application	Charge Voltage(V/Cell)			Max.Charge Current	Final Discharge Voltage V/Cell	1.75	1.70	1.60	1.30
	Temperature	Set Point	Allowable Range						
Cycle Use	25°C(77°F)	2.45	2.40-2.50	0.25C	Discharge Current(A)	0.2C>(A)	0.2C<(A)<0.5C	0.5C<(A)<1.0C	(A)>1.0C
Standby	25°C(77°F)	2.30	2.27-2.30						



ISO 9001 :2008

Let UPG Power Your Life.

www.upgi.com