

Absorbant Glass Mat (AGM) technology for superior performance. Valve regulated, spill proof construction allows safe operation in any position. Approved for transport by air. D.O.T., I.A.T.A., F.A.A. and C.A.B. certified. U.L. recognized under file number MH 20567.

Maintenance-Free

Specification

| | | | |
|---|----------------------------------|--------------|---------------|
| Nominal Voltage | 12 volts | | |
| Nominal Capacity | 77° F (25° C) | | |
| 20-hr. (0.450A) | 9 Ah | | |
| 10-hr. (0.830A) | 8.3 Ah | | |
| 5-hr. (1.53A) | 7.65 Ah | | |
| 1-hr. (5.40A) | 5.4 Ah | | |
| Approximate Weight | 5.17 lbs (2.35 kg) | | |
| Internal Resistance (approx.) | 19mΩ | | |
| Shelf Life (% of normal capacity at 77° F (25° C)) | | | |
| 3 Months | 6 Months | 12 Months | |
| 91% | 82% | 64% | |
| Temperature Dependency of Capacity (20 hour rate) | | | |
| 104° F (40° C) | 77° F (25° C) | 32° F (0° C) | 5° F (-15° C) |
| 102% | 100% | 85% | 65% |
| AGM Operational Temperature | | | |
| Charge | 32° F to 104° F (0° C to 40° C) | | |
| Discharge | 5° F to 113° F (-15° C to 45° C) | | |
| AGM Storage Temperature | 5° F to 104° F (-15° C to 40° C) | | |



Due to continuous improvements to our products, product images may vary slightly from depiction.

| | | |
|---|-----------------|------------------|
| Charge Method (Constant Voltage) | | |
| Cycle Use (Repeating Use) | Initial Current | 2.7 A or smaller |
| | Control Voltage | 14.6 - 14.8 V |
| Float Use | Control Voltage | 13.6 - 13.8 V |

Physical Dimensions: in (mm)

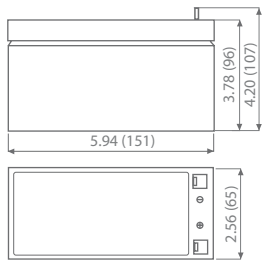

L: 5.94in (151 mm)
W: 2.56in (65 mm)
H: 3.78in (96 mm)
TH: 4.20in (107 mm)
 Tolerances are +/- 0.04 in. (+/- 1mm) and +/- 0.08 in. (+/- 2mm) for height dimensions. All data subject to change without notice.

Terminals

T Series (Tab Terminal)

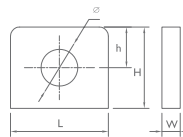

| Type | Dimension | L | W | H | h | ø |
|------|-----------|--------------------|-------------------|------------------|-------------------|-------------------|
| T5 | | 10.0 mm 0.39 in | 1.5 mm 0.06 in | 12 mm 0.47 in | 5.0 mm 0.12 in | 5.4 mm 0.21 in |

Discharge Time vs. Discharge Current

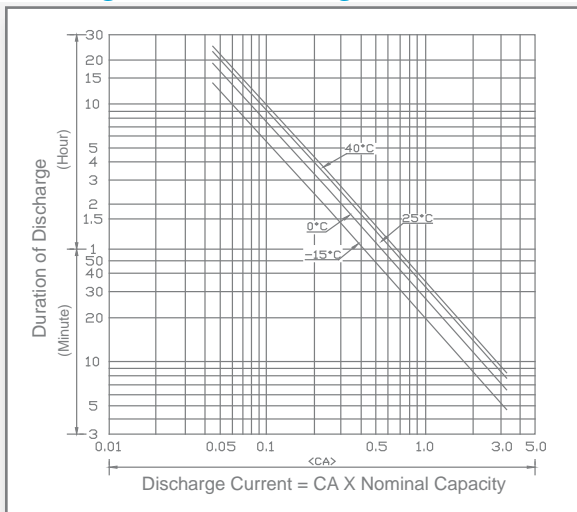

Discharge Characteristics

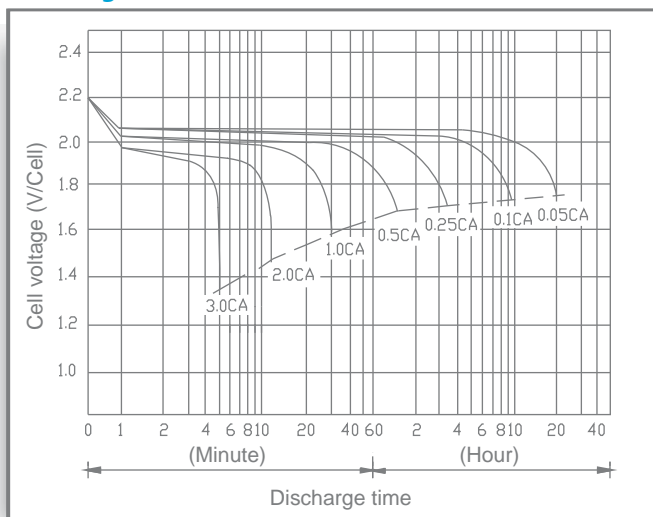

Shelf Life & Storage

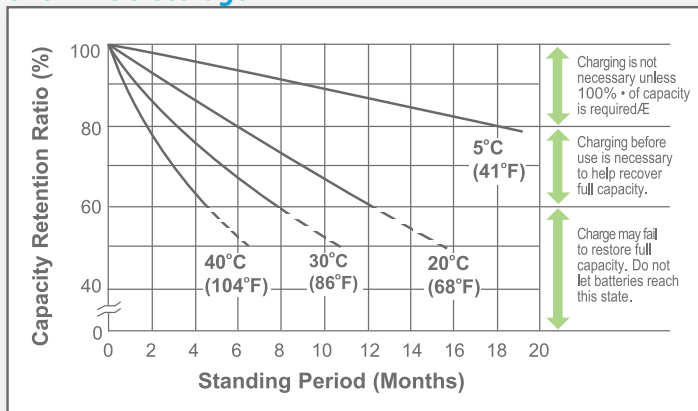

Cycle Life vs Depth of Discharge

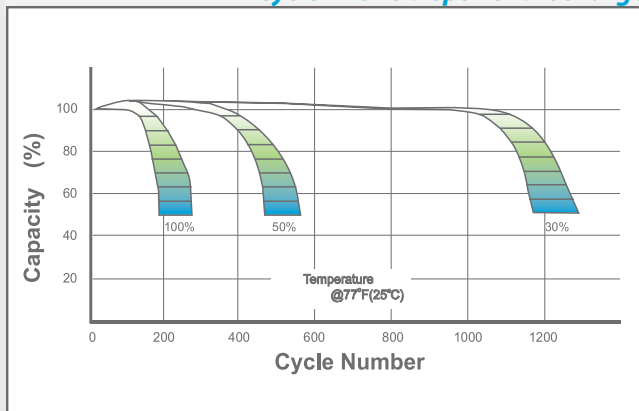

Open Circuit Voltage vs Residual Capacity

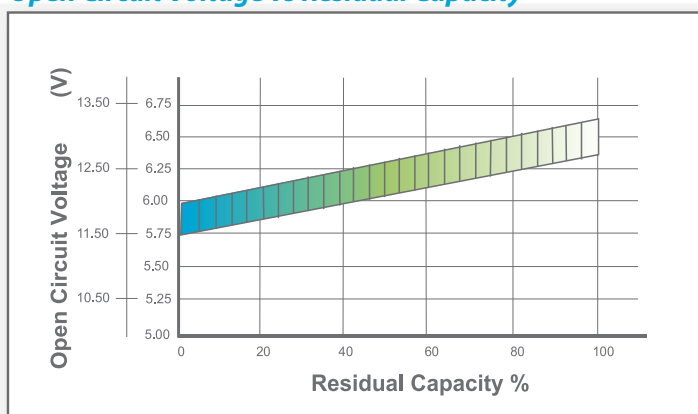

Effect of Temperature on Capacity

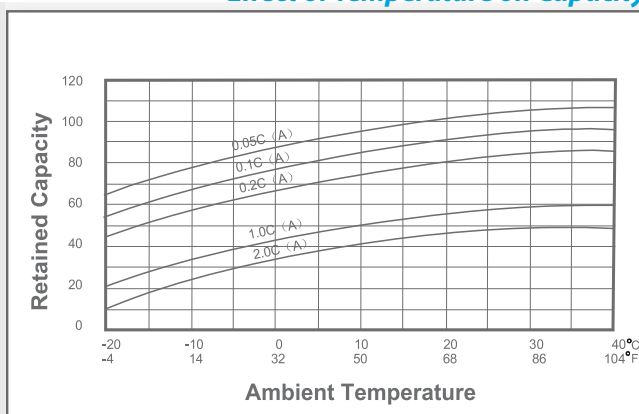

Charge Current & Final Discharge Voltage

| Application | Charge Voltage(V/Cell) | | | Max.Charge Current | Final Discharge Voltage V/Cell | 1.75 | 1.70 | 1.60 | 1.30 |
|-------------|------------------------|-----------|-----------------|--------------------|--------------------------------|----------|---------------|---------------|----------|
| | Temperature | Set Point | Allowable Range | | | | | | |
| Cycle Use | 25°C(77°F) | 2.45 | 2.43-2.47 | 0.30C | Discharge Current(A) | 0.2C>(A) | 0.2C<(A)<0.5C | 0.5C<(A)<1.0C | (A)>1.0C |
| Standby | 25°C(77°F) | 2.28 | 2.27-2.30 | | | | | | |



Let UPG Power Your Life.

www.upgi.com